

Summation Transformer DS11

Summation transformers are used for combination of several synchronous alternating currents (AC) in the same phase. To measure the total burden, the primary currents of the various current transformers must be added together. For example, with a current transformer of 100/5A and a current transformer of 200/5A, the kWh meter must be set to 300/5A.

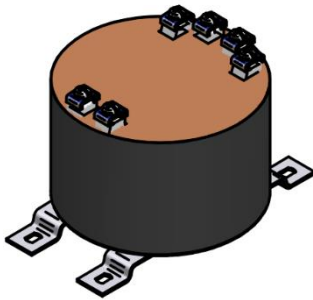

Order Specifications

Ratio	Class	Burden	Article Number
5+5/5A	0,5-1-3	10-15-20VA	4D2001
5+5+5/5A	0,5-1-3	10-15-20VA	4D2002
5+5/5A	0,2S	5VA	4D2003
1+1+1/1A	1	5VA	4D2010

Technical Specifications

<i>Environmental conditions</i>	
This product is designed to be safe under the following conditions:	
Location:	Indoor use
Operating temperature:	-10°C .. +55°C
Relative humidity:	5% .. 85%, non condensing
Protection degree:	IP00
<i>Application conditions</i>	
Standard:	IEC61869-2
Rated short-time thermal current:	60 x In / 1s
Rated continuous thermal current:	100%
Rated insulation level:	0,72/3/-kV
Rated frequency:	50/60Hz
Class of insulation:	E
Secondary leads:	Spring Pressure Connector, max 1.5mm ²
Class:	0,2, 0,5, 1 or 3
Burden:	5VA, 7,5VA, 10VA, 15VA, 30VA, 60VA of 120VA

Wiring Diagram

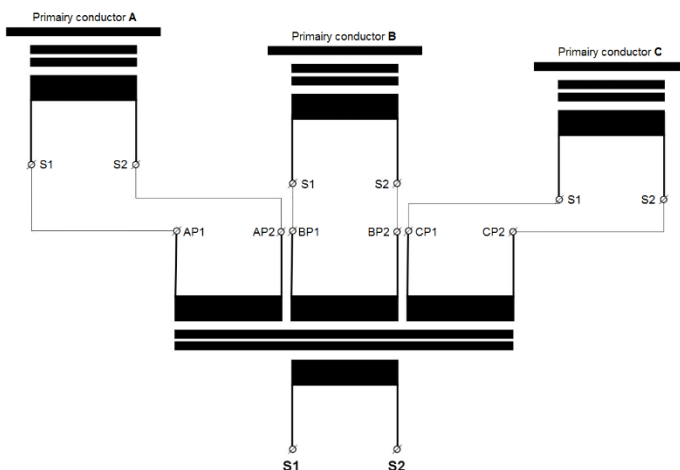

Dimensions*

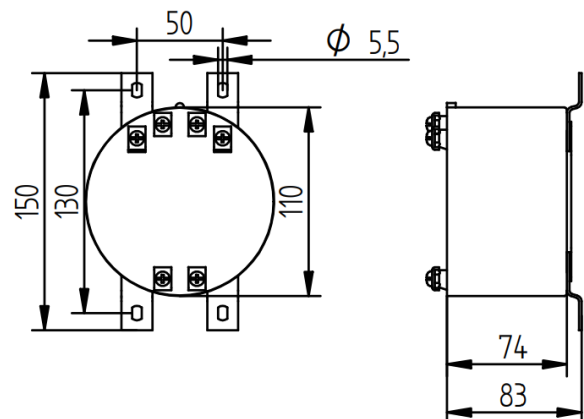

* Drawing intended for summations, multiple summations are also possible.

